

**CONNALLY STREET**  
(40' PUBLIC R/W)

**TUSKEGEE STREET**  
(50' PUBLIC R/W)

**FARRINGTON AVENUE**  
(30' PUBLIC R/W)

**MARTIN STREET**  
(40' PUBLIC R/W)

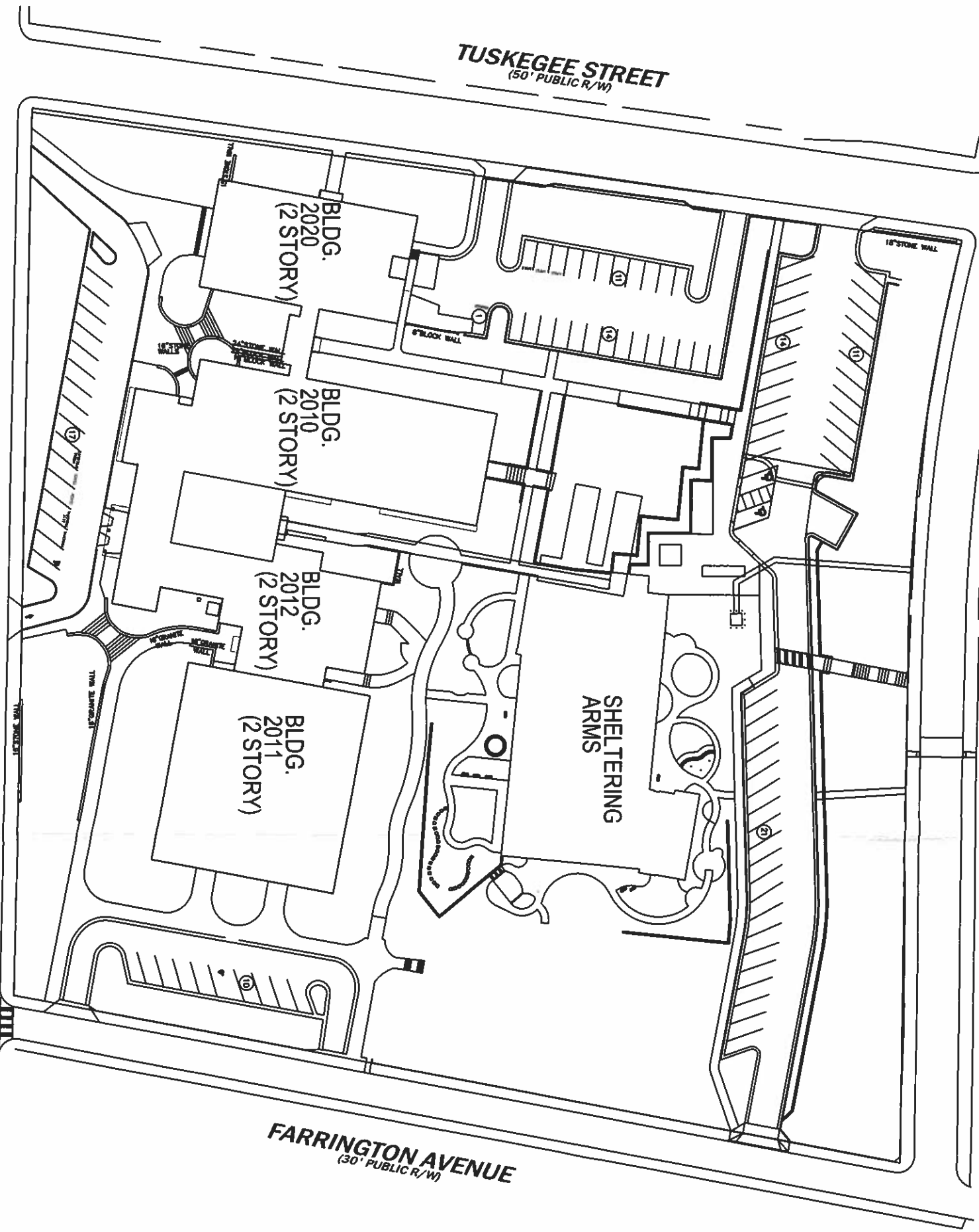

**GADOE SQUARE FOOTAGE**  
EXTERIOR: 42,384 SF  
INTERIOR: 75,646 SF



Atlanta Public Schools  
Facilities  
Service Center  
1631 La France Street, N.E.  
Atlanta, Georgia 30307

**BARACK & MICHELLE  
OBAMA ACADEMY**

970 Martin Street, S.E.  
Atlanta, Georgia 30315

Georgia DOE Facility Number:  
**5066**

Us:	38
FTE:	575
Site Area:	6.0 Acres
Total Building Area:	75,646 s.f.

DOE Building Number:	Date Occupied
2010	1999
2011	1968
2012	1968
2020	1968
RENOVATION ONLY	1999

Key Plan

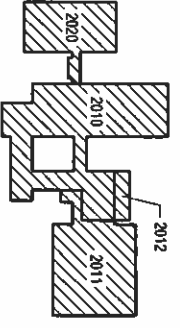

Date: 2019 Property Inventory  
Revision:

Sheet Title:

**SITE PLAN**

Sheet Number:  
**C1**

**SITE PLAN**

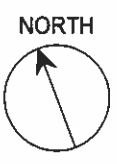
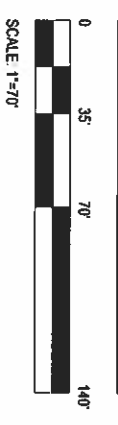

RLA	38
FTE	575
Site Area	6.0 Acres
Total Building Area	75,646 s.f.

DOE Building Number	Date Occupied
2010	1959
2011	1988
2012	1988
2020	1968
RENOVATION ONLY	
	1999

Key Plan:

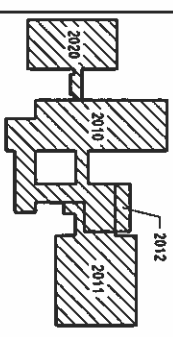

Date: 2017 Property Inventory

Revision:

Sheet Title:

**MAIN FLOOR**

Sheet Number:

A2

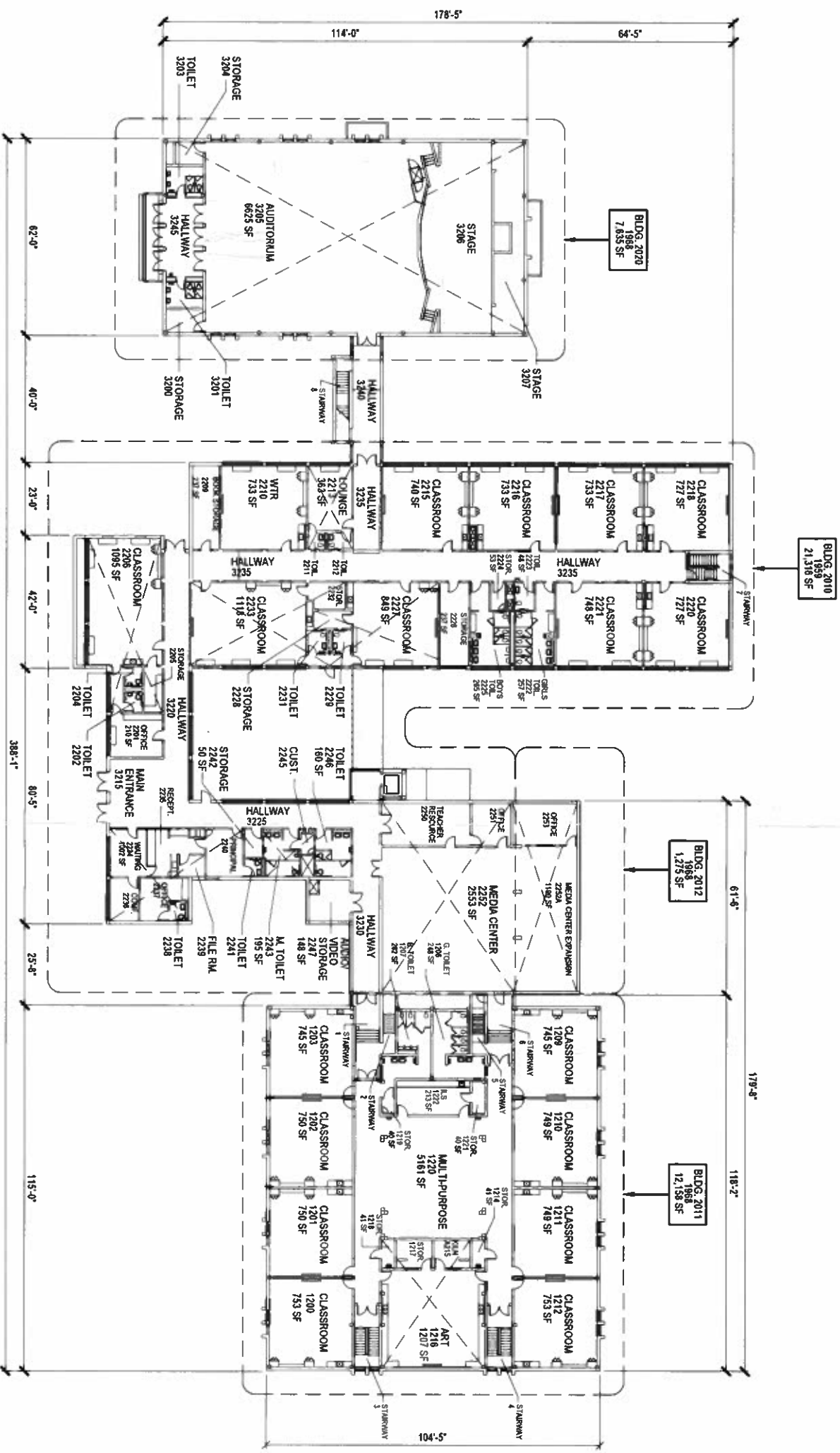

**MAIN FLOOR PLAN**



ILU:	38
FTE:	575
Site Area:	6.0 Acres
Total Building Area:	75,646 s.f.

DOE Building Number	Data Occupied
2010	1999
2011	1988
2012	1988
2020	1988
RENOVATION ONLY	
	1999

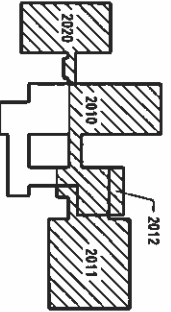

Date: 2017 Property Inventory  
 Revision:  
 Sheet Title:  
**LOWER FLOOR**

Sheet Number:  
**A1**

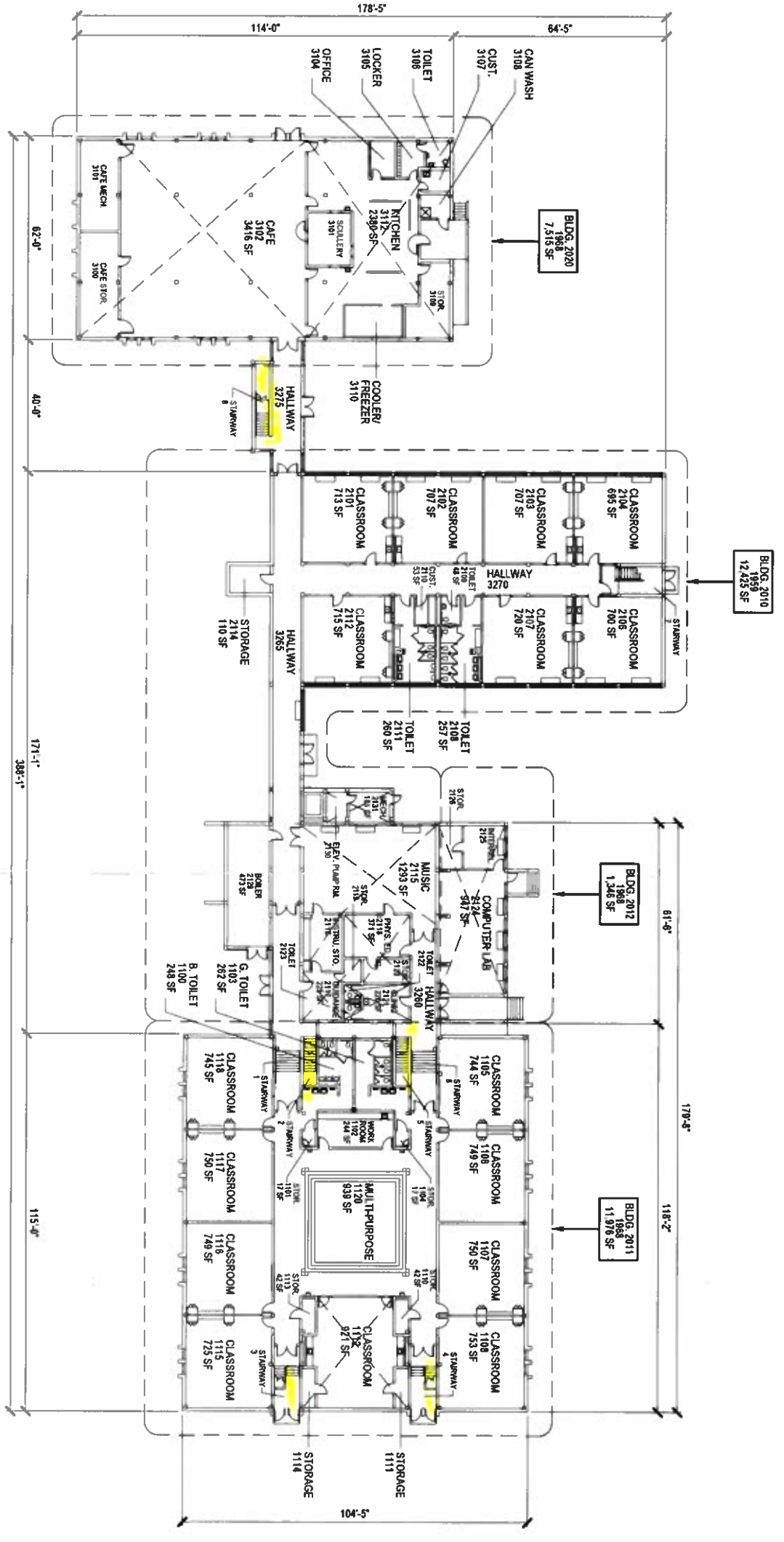

**LOWER FLOOR PLAN**



