

Georgia DOE Facility Number:  
**5664**

IUs:	42
FTE:	650
Site Area:	5.8 Acres
Total Building Area:	79,630 s.f.

DOE Building Number:	Date Occupied
401.1	1966
402.2	1994

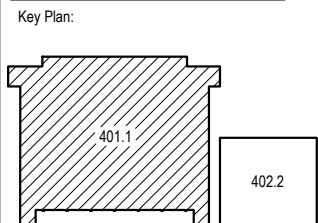

Date: 2017 Property Inventory

Revision:

Sheet Title:  
**SECOND FLOOR**

Sheet Number:  
**A2**

BLDG. 401.1  
 1966  
 37,617 SF

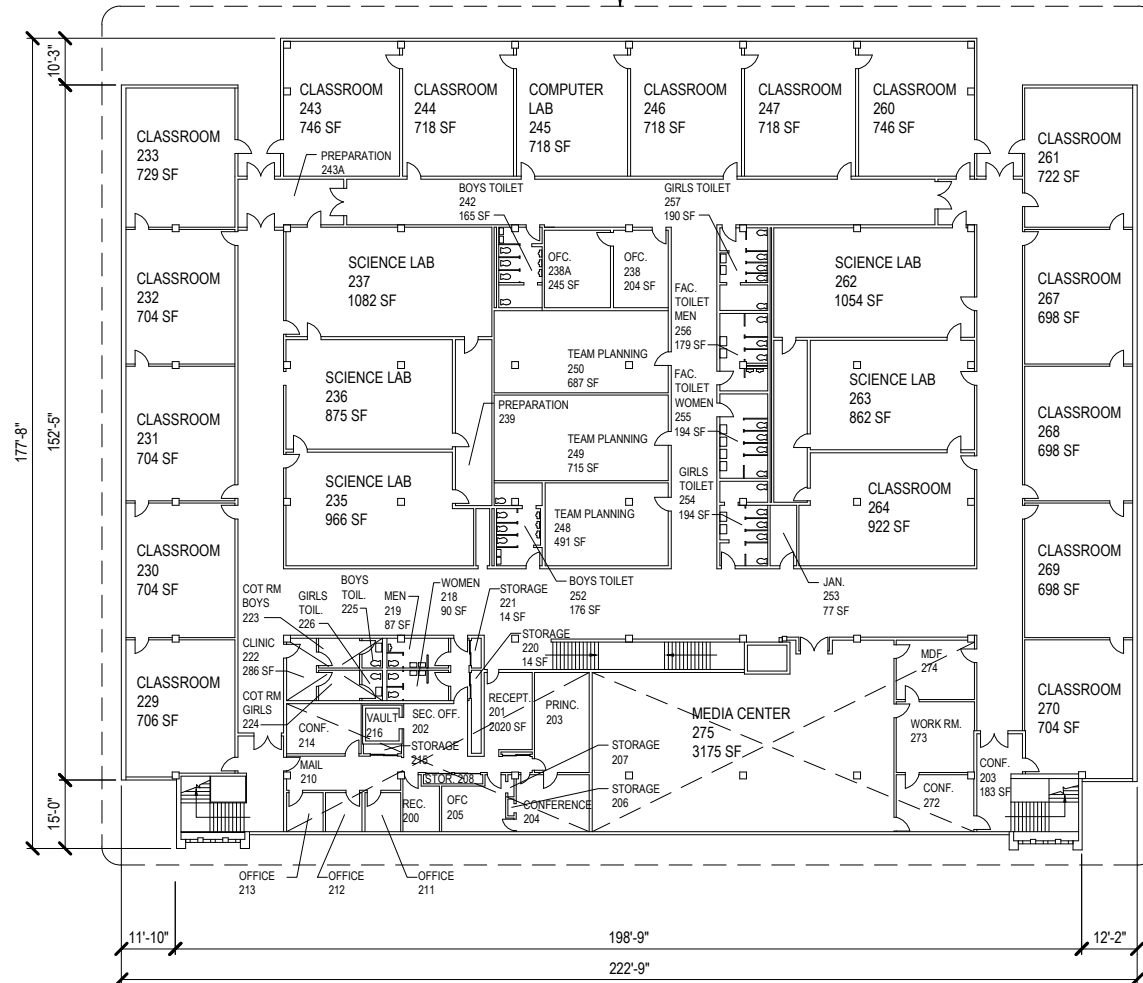

**SECOND FLOOR PLAN**

